

# MXM220•221

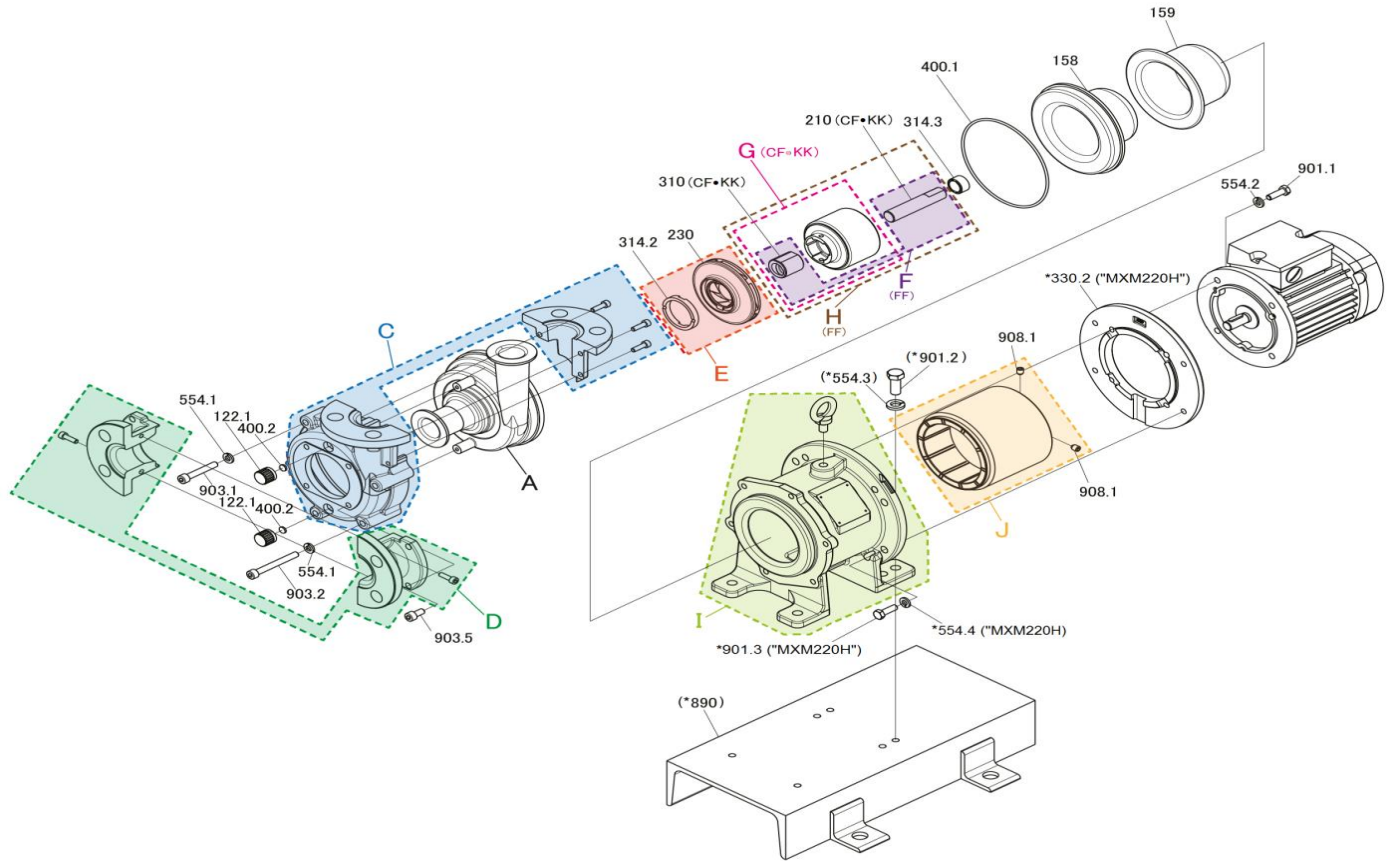

Item	Description		Q'ty	Type	Material	Part No.	Code No.
A	Corps avant + butée		1	CF•FF	CFRETFE+Ceramic	<b>MXM0170</b>	1210042110
			1	KK	CFRETFE+SiC	<b>MXM0171</b>	1210042120
C	Renfort A / B (ISO)	25mm	1	ISO	Ductile Iron	<b>MXM0231</b>	1220329320
		1"	1	ANSI	Ductile Iron	<b>MXM0241</b>	1220329330
		25mm	1	JIS	Ductile Iron	<b>MXM0168</b>	1220329310
D	Renfort 'C' (ISO)	25mm	1	ISO	Ductile Iron	<b>MXM0232</b>	1220329420
		1"	1	ANSI	Ductile Iron	<b>MXM0242</b>	1220329430
		25mm	1	JIS	Ductile Iron	<b>MXM0169</b>	1220329410
122.1	Bouchon de purge (M14x2)		2		ETFE	<b>MXM0114</b>	1240644600
158	Corps arrière		1	H	CFRETFE	<b>MXM0172</b>	1231190100
159	Renfort de corps arrière		1	H	FRP	<b>MXM0173</b>	1231190200
210	Axe		1	CF	Alumina Ceramic	<b>MX0118</b>	1240725000
			1	KK	SiC	<b>MX0427</b>	1240765100
230	Turbine <1> [1XF]	Ø 100 mm	1	1001	CFRETFE	<b>MXM0198</b>	1240862710
		Ø 90 mm	1	0901	CFRETFE	<b>MXM0199</b>	1240862720
		Ø 70 mm	1	0701	CFRETFE	<b>MXM0201</b>	1231021650
	Turbine <2> [2XF]	Ø 105 mm	1	1052	CFRETFE	<b>MXM0202</b>	1240908940
310	Palier		1	CF	High Density Carbon	<b>MX0475</b>	1240764800
			1	KK	SiC	<b>MX0476</b>	1240764900
F	Ensemble Axe + Palier<210+310>		1	FF	Alumina Ceramic	<b>MXM0365</b>	2270326720
314.2	Bague avant		1	CF•FF	PTFE	<b>MX0208</b>	1240752800
			1	KK	SiC	<b>MX0472</b>	1240860100
314.3	Butée arrière		1		CFRETFE	<b>MX0428</b>	1240764700
I	Entretoise	0,37•0,75kW	1	220•221-H	Ductile Iron	<b>MXM0209</b>	1210042420
330.2	Bride moteur	0,37kW	1	220-H	Ductile Iron	<b>MXM0211</b>	1231190300
400.1	Joint torique <G-140>		1	V	FKM-A	<b>MXM0218</b>	0325300485
			1	E	EPDM	<b>MXM0220</b>	0325300486
			1	A	Aflas®	<b>MXM0221</b>	0325300487
			1	P	DAI-EL Perfluoro®	<b>MXM0217</b>	0325300488
400.2	Joint (t: 2mm, Ø 12mm)		2	V	FKM	<b>MXM0009</b>	1240010300
			2	E	EPDM	<b>MXM0010</b>	1240014200
			2	A	Aflas®	<b>MXM0011</b>	1240102200
			2	P	DAI-EL Perfluoro®	<b>MXM0015</b>	1240465900

⚠ Subject to change without prior notice!

⚠ Actual pump may differ from the exploded view!

# MXM220•221

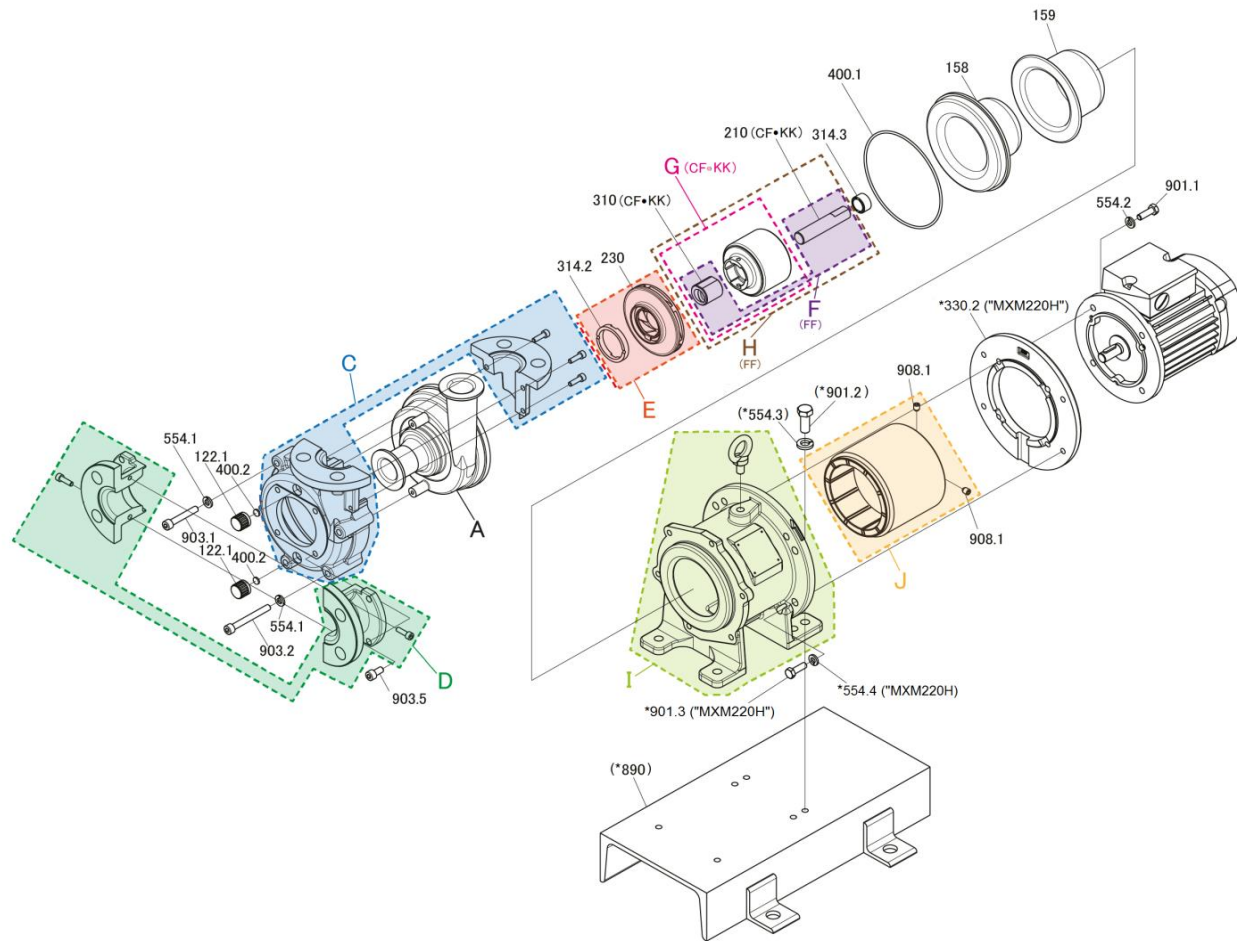

Item	Description	Q'ty	Type	Material	Part No.	
J	<b>Entraineur</b> (avec 2x908.1)	0,37kW [XMJ20H]	1	<b>220-H</b>	Ductile Iron+Mag.	<b>MXM0207</b>
		0,75kW [XMJ21H]	1	<b>221-H</b>	Ductile Iron+Mag.	<b>MXM0251</b>
G	<b>Capsule mag. + Palier</b>	0,37kW	1	<b>220-CF</b>	CFRETFE+Carbon	<b>MX0424</b>
			1	<b>220-KK</b>	CFRETFE+SiC	<b>MX0426</b>
		0,75kW	1	<b>221-CF</b>	CFRETFE+Carbon	<b>MX0443</b>
			1	<b>221-KK</b>	CFRETFE+SiC	<b>MX0445</b>
554.1	<b>Rondelle grower (Renfort 'A/B') M8</b>	6		SUS304 equivalent	<b>MDM0028</b>	
554.2	<b>Rondelle (Moteur) M8</b>	4	<b>220</b>	SUS304 equivalent	<b>MDM0028</b>	
	<b>Rondelle (Moteur) M10</b>	4	<b>221</b>	SUS304 equivalent	<b>MDM0030</b>	
554.4	<b>Rondelle (Bride moteur) M8</b>	4	<b>220</b>	SUS304 equivalent	<b>MDM0028</b>	
901.1	<b>Vis (Moteur) M8x20</b>	4	<b>220</b>	SUS304 equivalent	<b>MDM0037</b>	
	<b>Vis (Moteur) M10x25</b>	4	<b>221</b>	SUS304 equivalent	<b>MDM0041</b>	
901.3	<b>Vis (Bride Moteur) M8x25</b>	4	<b>220</b>	SUS304 equivalent	<b>MXM0215</b>	
903.1	<b>Vis (Renfort 'A/B') M8x50</b>	3		SUS304 equivalent	<b>MXM0212</b>	
903.2	<b>Vis (Renfort 'A/B') M8x70</b>	3		SUS304 equivalent	<b>MXM0213</b>	
908.1	<b>Vis (Entraineur) M8x10</b>	2	<b>220•221</b>	Steel	<b>MDM0044</b>	
E	<b>Turbine &lt;1&gt; + Bague Avant</b>	Ø 100 mm	1	<b>1001-CF•FF</b>	CFRETFE+PTFE	<b>MXM0186</b>
		Ø 90 mm	1	<b>0901-CF•FF</b>	CFRETFE+PTFE	<b>MXM0187</b>
		Ø 70 mm	1	<b>0701-CF•FF</b>	CFRETFE+PTFE	<b>MXM0189</b>
	<b>Turbine &lt;2&gt; + Bague</b>	Ø 105 mm	1	<b>1052-CF•FF</b>	CFRETFE+PTFE	<b>MXM0190</b>
	<b>Turbine &lt;1&gt; + Bague Avant</b>	Ø 100 mm	1	<b>1001-KK</b>	CFRETFE+SiC	<b>MXM0192</b>
		Ø 90 mm	1	<b>0901-KK</b>	CFRETFE+SiC	<b>MXM0193</b>
		Ø 70 mm	1	<b>0701-KK</b>	CFRETFE+SiC	<b>MXM0195</b>
<b>Turbine &lt;2&gt; + Bague</b>		Ø 105 mm	1	<b>1052-KK</b>	CFRETFE+SiC	<b>MXM0196</b>
H	<b>Capsule mag. + Palier + Axe</b>	0,37kW	1	<b>220-FF</b>	CFRETFE+Ceramic	<b>MXM0361</b>
		0,75kW	1	<b>221-FF</b>	CFRETFE+Ceramic	<b>MXM0362</b>
*890	<b>Base</b>	1	<b>"B"</b>	Steel	<b>MXM0222</b>	
*554.3	<b>Rondelle Grower (Base) M10</b>	4	<b>"B"</b>	SUS304 equivalent	<b>MDM0030</b>	
*901.2	<b>Vis (Base) M10x30</b>	4	<b>"B"</b>	SUS304 equivalent	<b>MDM0040</b>	

Note: Items asterisked (\*) are optional parts.

⚠ Subject to change without prior notice! ⚠ Actual pump may differ from the exploded view!