

# LK-F11•21•22 (PVC)

No. 85-051  
Mar. 01, 2006

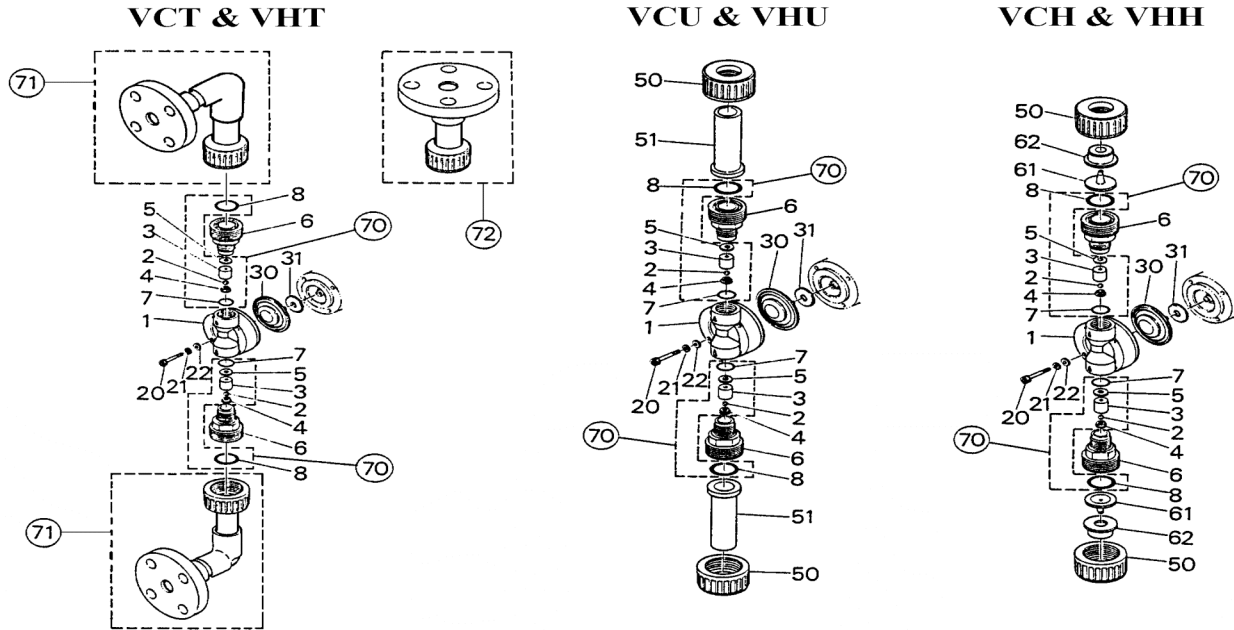

Item	Description	Q'ty	Material	LK-F11		LK-F21•22	
				Part No.		Part No.	
1	Pump Head	1	PVC	L0001		L0031	
2	Valve Ball	VC	Alumina Ceramic	L0003		L0033	
		VH	HastelloyC276	L0002		L0032	
3	Valve Guide	2	PVC	L0004		L0034	
4	Valve Seat	VC	FKM-A	L0006		L0036	
		VH	EPDM	L0005		L0035	
5	Valve Gasket	2	PTFE	L0008		ï	
6	Adapter	2	PVC	L0012		ï	
7	O-Ring, S-14	VC	FKM-A	L0014		ï	
		VH	EPDM	L0013		ï	
8	O-Ring, P-20	VC	FKM-A	L0016		ï	
		VH	EPDM	L0015		ï	
20	Cap Bolt	M4x35	SUS304 equiv.	L0017			
	Hex. Head Bolt	M5x30	SUS304 equiv.			L0047	
21	Spring Washer	M4	SUS304 equiv.	L0018			
		M5	SUS304 equiv.			L0048	
22	Plate Washer	M4	SUS304 equiv.	L0019			
		M5	SUS304 equiv.			L0049	
30	Diaphragm	1	PTFE (+EPDM)	L0020		L0050	
31	Retainer Plate	1	SUS304	L0021		L0051	
50	Nut <"U"•"H">	2	PVC	L0022		ï	
51	Union (VP16) <"U">	2	PVC	L0024		ï	
61	Tube Insert (4x9mm) <"H">	2	PVC	L0026		ï	
62	Ferrule (4x9mm) <"H">	2	Steel	L0027		ï	
70	Valve Set	VC	Ceramic+FKM-A	L0010		L0040	
		VH	HC276+EPDM	L0009		L0039	
71	Flange Unit (Elbow) <"T">	DN 15	PVC	L1413		ï	
*71	Flange Unit (Elbow)	JIS 15	PVC	L0030		ï	
*72	Flange Unit (Straight)	JIS 15	PVC	L0029		ï	

Note: Items Nos. 71 and 72 marked with \* (JIS) are optional parts.

⚠ Subject to change without prior notice! ⚠ Actual pump may differ from the exploded view!